

Quick Start Guide

SNAP
Controller | External Sensor

Before Hand

Connect External Sensor to SNAP like so...
Mount the sensor Up-right to avoid contamination and closest to the location where you want to control. The reading you see on the screen will show you the reading of the external sensor.

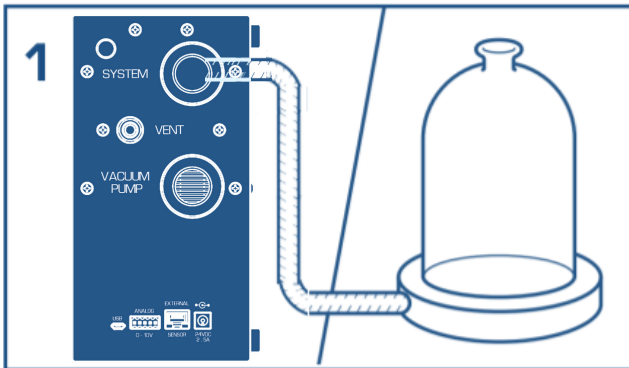
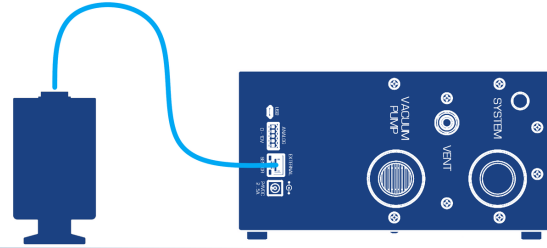

1 Connect system

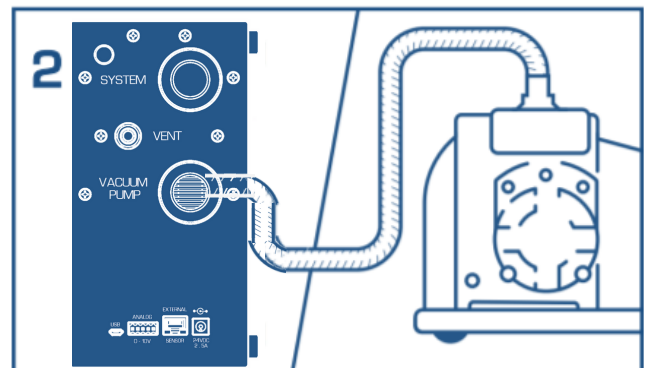

2 Connect vacuum

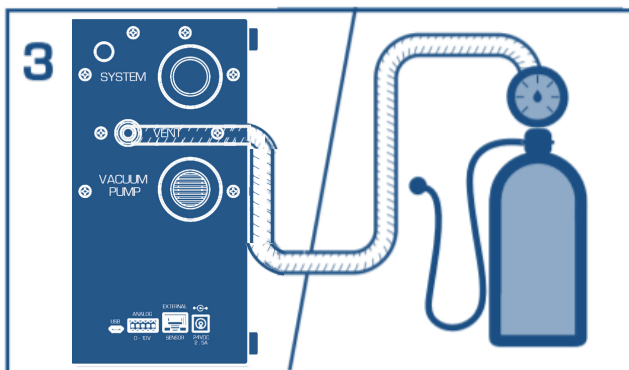

3 (Optional) Connect Vent to nitrogen or other inert gas or leave open to air

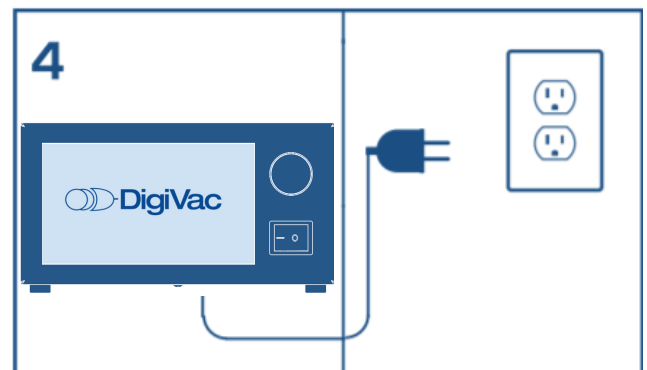

4 Plug in and power on

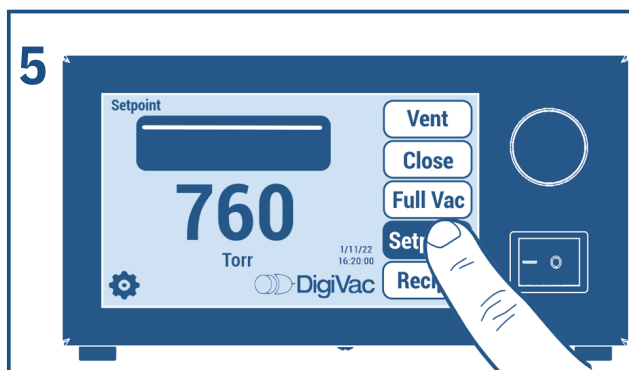

5 Select Set point as shown (or other options such as Mode or Recipe and play)



6 Control at Set point (or run Recipe, Vent, Close or Open valves) at a button's touch!